

r. **Fast<sup>®</sup>A**  
Mineral wool  
insulation slab

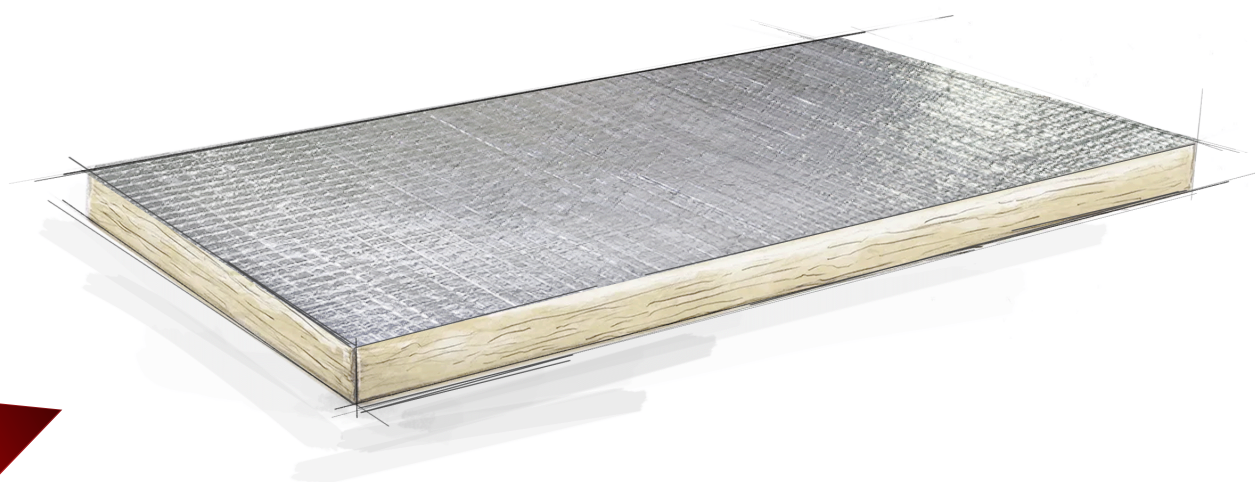

**Energy to live**



**ROHHE<sup>®</sup>**

## Product

r. **Fast®A**

is a mineral wool slab covered with a cladding of reinforced aluminium foil. The mineral wool used provides excellent thermal, mechanical and sound-proofing properties, as well as high temperature resistance (up to 250°C). The appropriate arrangement of mineral wool fibres provides the slab with high rigidity and guarantees the stability of mechanical properties. Covering the outer surface with reinforced aluminium foil acts as a barrier to water vapour and protects against damage and penetration of wool fibres into the environment. Low chloride ion content (CL10) reduces the risk of corrosion of insulated components.

### Cladding structure

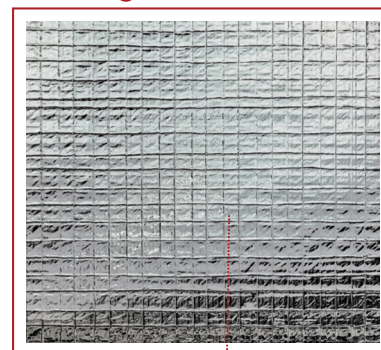

aluminium foil reinforced with mesh

### Insulation of rectangular ventilation duct

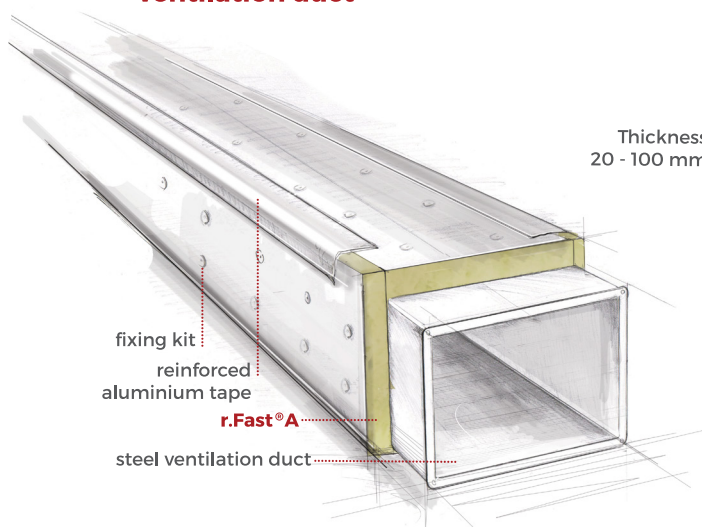

### Product structure

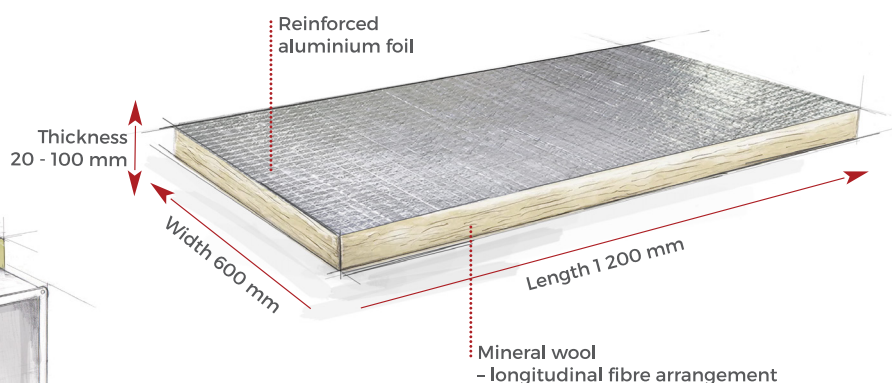

## Application

r. **Fast®A**

is designed for thermal, anti-condensation and acoustic insulation of vertical and horizontal elements of technical and building installations. A typical application is the insulation of steel ventilation and air conditioning ducts. Installation is carried out using a typical fastening system (pin, clamping plate, cap, tape, band).

## Improving the aesthetics of the insulated duct

r. **Fast<sup>®</sup>A**

through its rigidity and rectangular form, ensures that the regular shape of the insulated ventilation duct is maintained with aesthetically sharp and even edges.

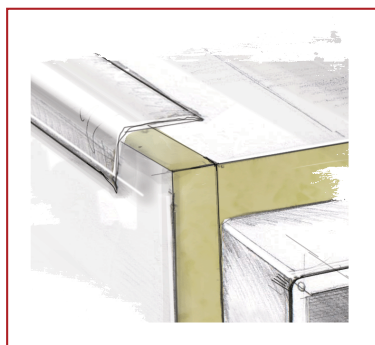

### Shape maintenance system

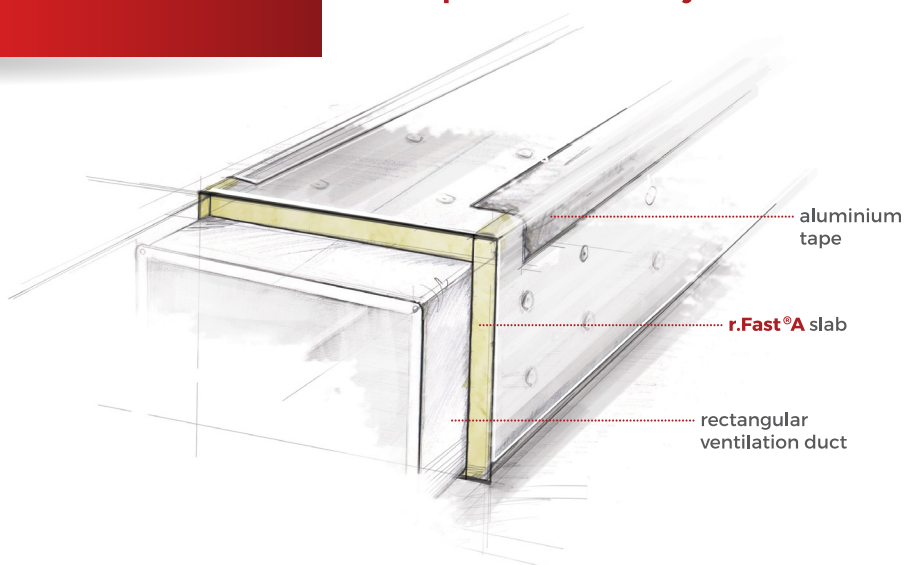

### Technical details

PARAMETER	VALUE	UNIT	SYMBOL	STANDARD
declared thermal conductivity (temp. 10°C)	0,035	W/m·K	$\lambda_D$	EN 12667
reaction to fire	incombustible	class	A1	EN 13501-1
short-term water absorption	$\leq 1$	kg/m <sup>2</sup>	WS1	EN 13472
maximum service temperature	250	°C	ST(+250)	EN 14706
trace amounts of soluble ions	$\leq 10$	ppm	CL10	EN 13468
water vapour permeability	$s_d \geq 200$	m	MV <sub>2</sub>	EN 12086
thickness tolerance	-3% lub -3mm/+5% lub 5mm	% lub mm	T4	EN 13467
width tolerance	$\pm 1,5\%$	%	-	EN 13467
length tolerance	$\pm 2\%$	%	-	EN 13467



Product CE code	MW-EN 14303-T4 -ST(+250)-WS1-MV2-CL10
Product Standard	EN 14303:2009+A1:2013
Product Documents	<a href="http://www.rohhe.com/documents">www.rohhe.com/documents</a>



### Values of declared thermal conductivity ( $\lambda_D$ ) at selected average temperatures

#### Temperature [°C]

	10	50	150	250
$\lambda$ [W/m·K]	0,035	0,040	0,057	0,079



## Packaging method

The **r.Fast®A** labs are packed in the form of parcels measuring 0.3 x 0.6 x 1.2 m and wrapped in heavy-duty tightly shrink-wrapped LDPE film. The packages are horizontally stacked on a pallet (1.2x1.2 m) in 8 layers. Each pallet contains 16 parcels of slabs. All pallets are protected by heavy-duty LDPE hoods and additionally wrapped with stretch film. Such a way of packaging effectively protects the product from damage and dirt during transport and storage operations.

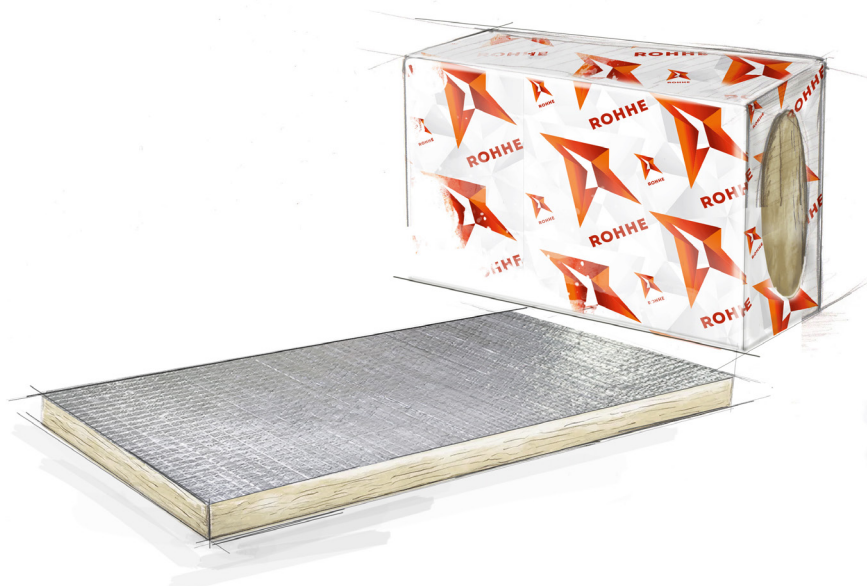

## Dimensions and quantity

### THICKNESS

QUANTITY IN THE PACKAGE QUANTITY IN THE PACKAGE QUANTITY ON A PALLET QUANTITY ON A PALLET

mm	Pcs	m <sup>2</sup>	Pcs	m <sup>2</sup>
20	15	10,80	240	172,80
30	10	7,20	160	115,20
40	6	4,32	96	69,12
50	6	4,32	96	69,12
60	5	3,60	80	57,60
80	3	2,16	60	43,20
100	3	2,16	48	34,56

### ROHHE Partner:

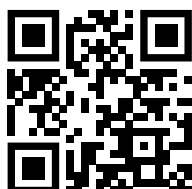

[www.rohhe.com](http://www.rohhe.com)

### ROHHE Sp. z o.o.

05-555 Tarczyn, Al. Krakowska 19A

tel. +48 22 299 88 33, [biuro@rohhe.pl](mailto:biuro@rohhe.pl)

Orders: 736 233 377, [zamowienia@rohhe.pl](mailto:zamowienia@rohhe.pl)

Logistics: 736 233 372, [logistyka@rohhe.pl](mailto:logistyka@rohhe.pl)

Sale - Poland: 736 233 371, 736 233 375, 797 654 015, 793 500 140,

736 233 378, 736 233 374, [sprzedaz@rohhe.pl](mailto:sprzedaz@rohhe.pl)

Sale - Export: 736 233 379, [export@rohhe.pl](mailto:export@rohhe.pl)

